

BPSXR

User Manual



1.1 Description



BPSXR load cells are a weighing sensor located at the fixed point of cables on traction elevators load. In dinacell we have developed different models of BPSXR sensors to be able to adapt them to the different types of installations

1.2 Dimensions in mm

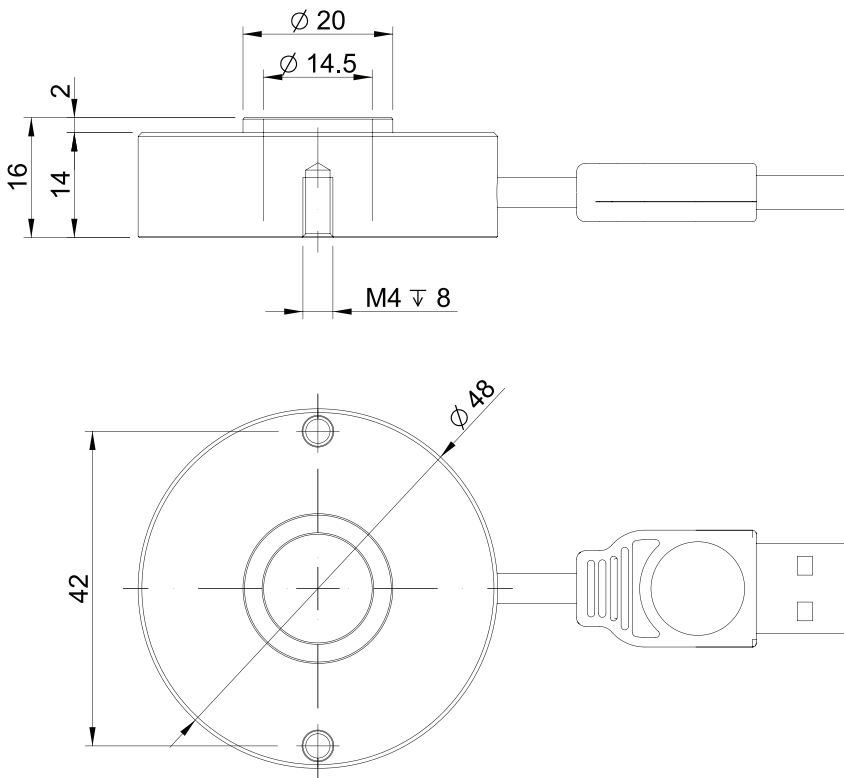

Wiring diagram

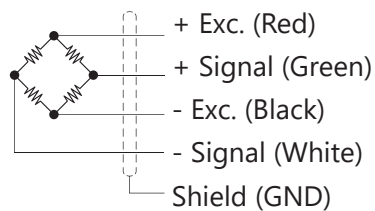

Installation step-by-step

2

2.1 Place and way of installation

These load cells must be installed at the fixed point of the elevator. Below you will find an installation scheme for the different types of suspensions.

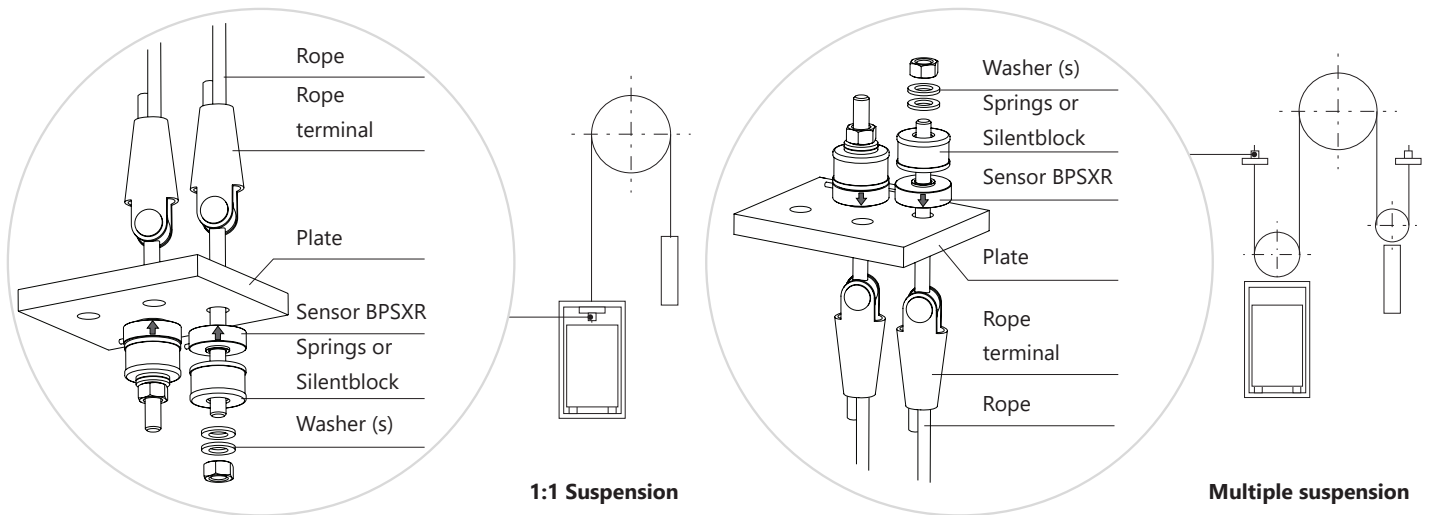

2.2 Minimum distance between sensor

FIGURE 1
Min. distance between load cells for installation

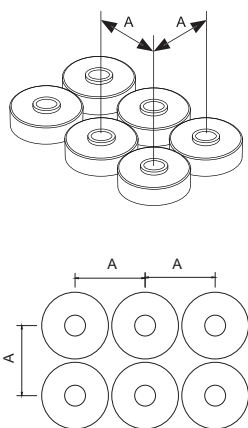

Model	(A)
BPSXR	50

2.3 Connecting cells to the device

Lastly, you must connect the cells USB to the load weighing control. To do this, you must take into account the steps indicated in the load weighing control manual to know when to make the connection.

If you connect multiple BPSXR sensors to a load weighing control with only one input, you must use an INTERFACE.

Dinacell Electronica S.L.

The information contained by the document is subject to change without notice. The content indicated herein should be used as an overview of the product. It should not be construed as a guarantee of quality or durability. Dinacell Electronic shall not be liable for technical or editing errors or omissions contained in this document.

Document Ref.: D2283-01

Publication date: 23/05/2025

Dinacell Electrónica S.L.

Pol. Ind. Santa Ana C/ El Torno N°8
CP 28522 Rivas Vaciamadrid, Madrid, ESPAÑA
Tel. (+34) 913 001 435 Fax. (+34) 913 001 645
dinacell@dinacell.com
www.dinacell.com