

## BP-2093 0.5 ... 5 t

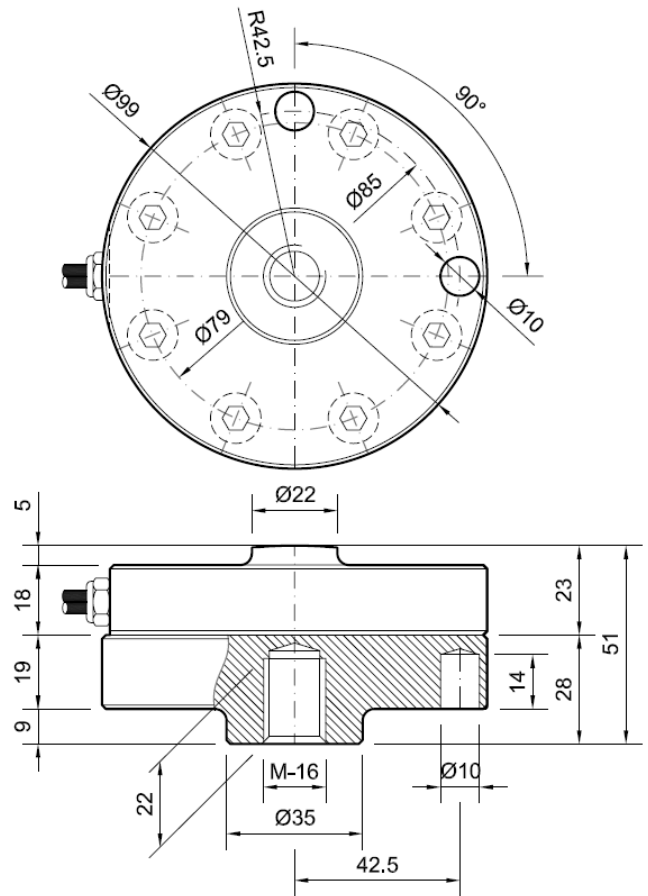

Dimensions in mm.



- Load cell specially designed to work with compression.
- It is usually applied in the automotive industry.

Wiring diagram

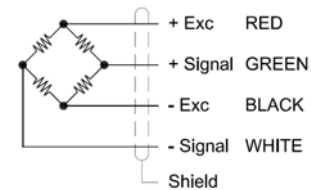

### Technical characteristics

Nominal load (nL)	0.5, 1, 3, 5 t	Maximum excitation voltage	12 V
Sensibility	2,0 mV/V ± 0.4 %	Minimum insulation resistance (V.Test = 100V)	4 GΩ
Tolerance adjust on zero	5 % F.S.	Maximum working load	150 % F.S.
Compensated temperature range	-10..40 °C	Breaking load	>300 % F.S.
Service temperature range	-20..60 °C	Protection class	IP67
Non linearity	0,044% F.S.	Cable type	Ø6 4x0,22 mm <sup>2</sup>
Histeresys error	0,047 % F.S.	Cable length	4 m
Input resistance	380 ± 10Ω	Material	Alloy steel
Output resistance	350 ± 2Ω	Surface treatment	Chemical nikel